



TOWN OF VIEW ROYAL NOTICE OF PROCESSING AN APPLICATION FOR A DEVELOPMENT VARIANCE PERMIT

NOTICE IS HEREBY GIVEN that an application for a Development Variance Permit is being considered for the property at **20 Edwards Estates**, as shown boldly outlined on the map on the reverse side of this Notice. The affected lot is legally described as:

STRATA LOT 5, SECTION 95, ESQUIMALT DISTRICT, STRATA PLAN VIS3057, TOGETHER WITH AN INTEREST IN THE COMMON PROPERTY IN PROPORTION TO THE UNIT ENTITLEMENT OF THE STRATA LOT AS SHOWN ON FORM 1

Development Variance Permit 2016/16 is a request to vary provisions of Zoning Bylaw No. 900, 2014 as follows:

- **A variance to Section 6.6.4 of Zoning Bylaw No. 900 to increase the maximum floor area from 325m² to 365m².**

The intended outcome of the variance is the retention of the detached garage in the front yard in conjunction with the renovations to the house.

The development proposal will be considered by **View Royal Town Council on Tuesday, December 13, 2016 at 7:00 pm** and may by resolution:

- authorize the issuance of the Development Variance Permit;
- authorize the issuance of the Development variance Permit as amended by Council in its resolution;
- defer consideration of the Development Variance Permit to a future date; or
- refuse to authorize a Development Variance Permit for the current proposal.

If you have any representations to make, Town Council would be pleased to hear them at the **December 13, 2016** Council meeting. If you are unable to attend the meeting, comments may be mailed, facsimiled, emailed, or hand-delivered to the Town Hall no later than 3:00pm on Tuesday, December 13, 2016. Submission information for comments is as follows:

- Mail: 45 View Royal Avenue, Victoria, BC, V9B 1A6
- Facsimile: 250-727-9551
- E-mail: info@viewroyal.ca

A copy of the application and related information may be inspected at the View Royal Town Hall (located at 45 View Royal Avenue, Victoria, BC, V9B 1A6) between the hours of 8:30am and 4:30pm, Monday to Friday, December 1, 2016 to December 13, 2016. Information may also be obtained by calling the Development Services Department at 250-479-6800.

Dated the 30th day of November, 2016.

Development Services, Town of View Royal

Subject Property Map - 20 Edwards Estates

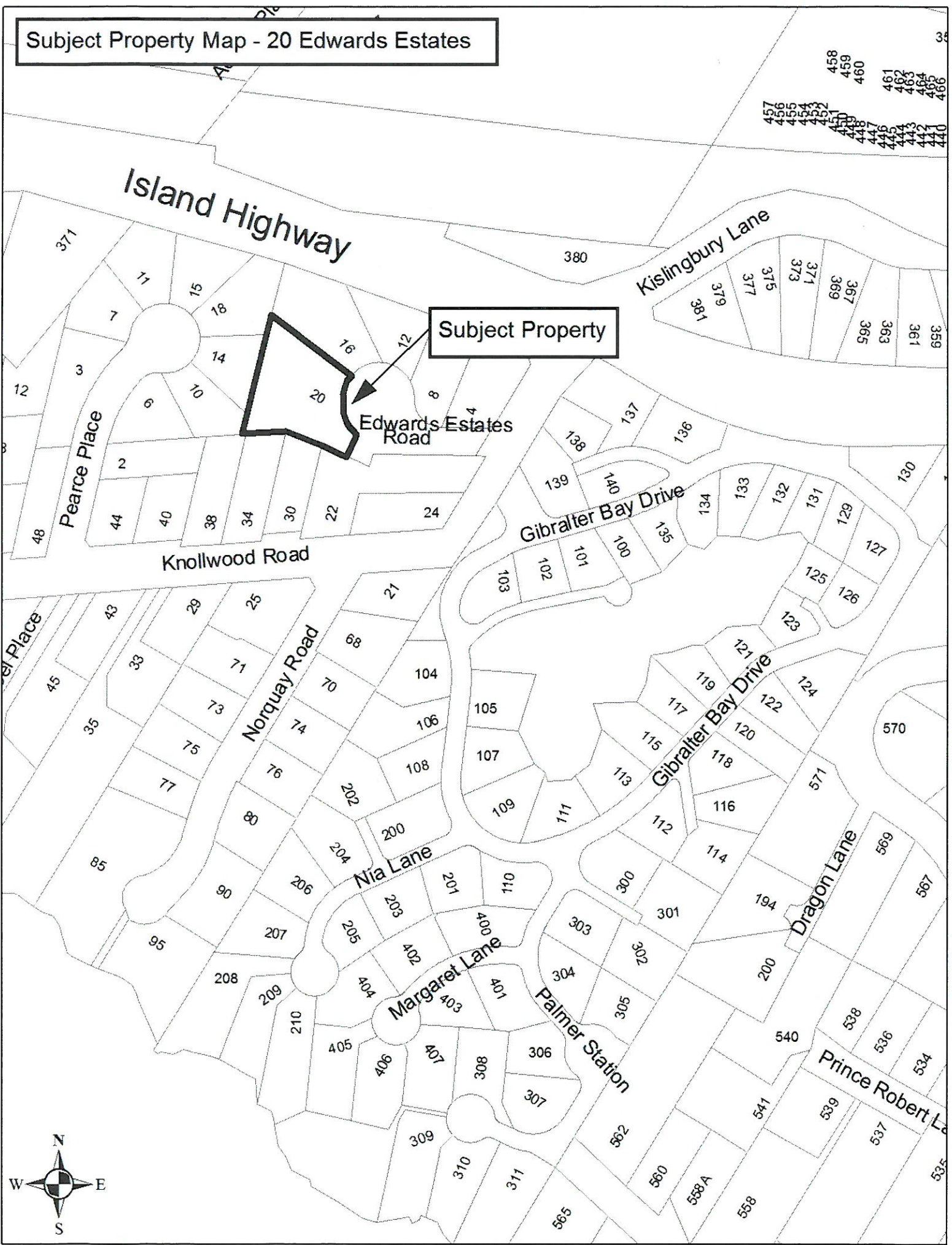

Subject Property

Edwards Estates
Road

Island Highway

Kislingbury Lane

Pearce Place

Gibraltar Bay Drive

Knollwood Road

Norquay Road

Gibraltar Bay Drive

Nia Lane

Margaret Lane

Palmer Station

Dragon Lane

Prince Robert Lane

